

Size 34 (86mm) Series

The size 34 [86mm] Hybrid Rotary Stepper Motor has Max. 7.0N·m of holding torque
Encoders solutions are available.

For special windings or customization,
Please contact DINGS' for further information.



Parameters

General							
Accuracy	Step angle		1.8°±5%				
	Resistance		±10% / 20 C				
	Inductance		±20% / 1KHz				
Insulation class			B				
Duty type			S1				
Dielectrical strength			500 VAC / 1 KHz / 1 mA / 1 s				
Insulation resistance			100 MΩ / 500 VDC				
Permissible radial load (5mm distance from mounting surface)		Permissible radial load (10mm distance from mounting surface)		Permissible radial load (15mm distance from mounting surface)		Permissible radial load (20mm distance from mounting surface)	
600N		550N		480N		390N	
Parameter							
Type	Current (A)	Resistance (Ω)	Inductance (mH)	Holding Torque (N·m)	Rotor Inertia (g·cm ²)	Length (mm)	Mass (g)
34H2060	3	1	6	3	1100	60.5	1600
34H2075	4.5	0.6	4.5	4.5	1800	75	2100
34H2098	6	0.5	3.5	7	2800	96.5	2900
Material							
End bell			Aluminum alloy				
Bearing			Deep groove ball bearing				
Magnet			Sintered NdFeb				
Shaft			Stainless steel				
Wiring			UL 3265, 18AWG				

Size 34 (86mm) Series

Dimensional Drawings

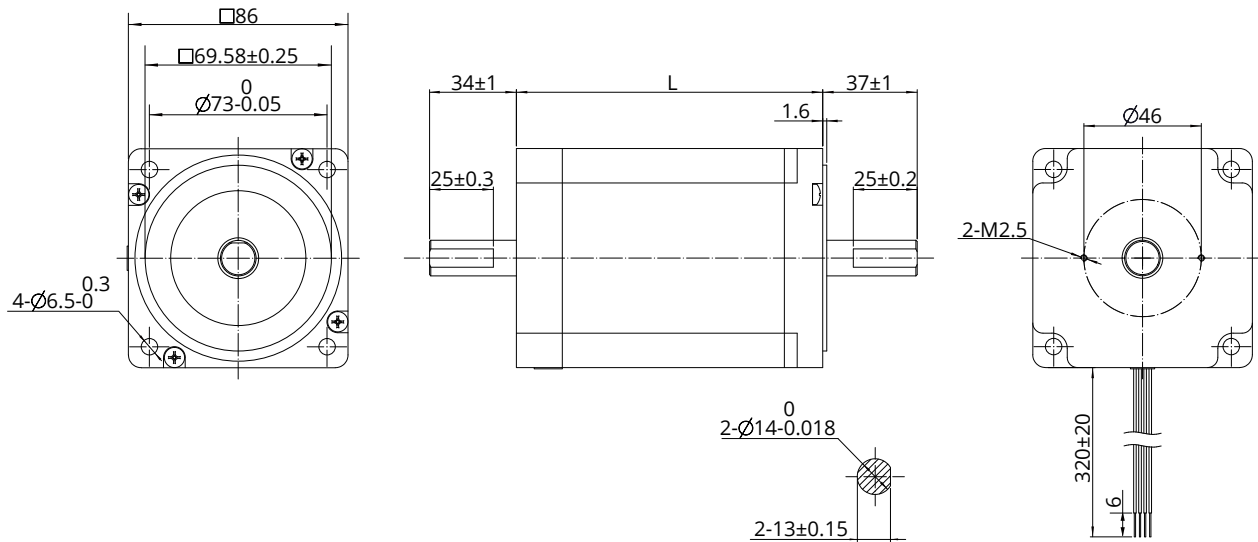

Torque Performance Curves

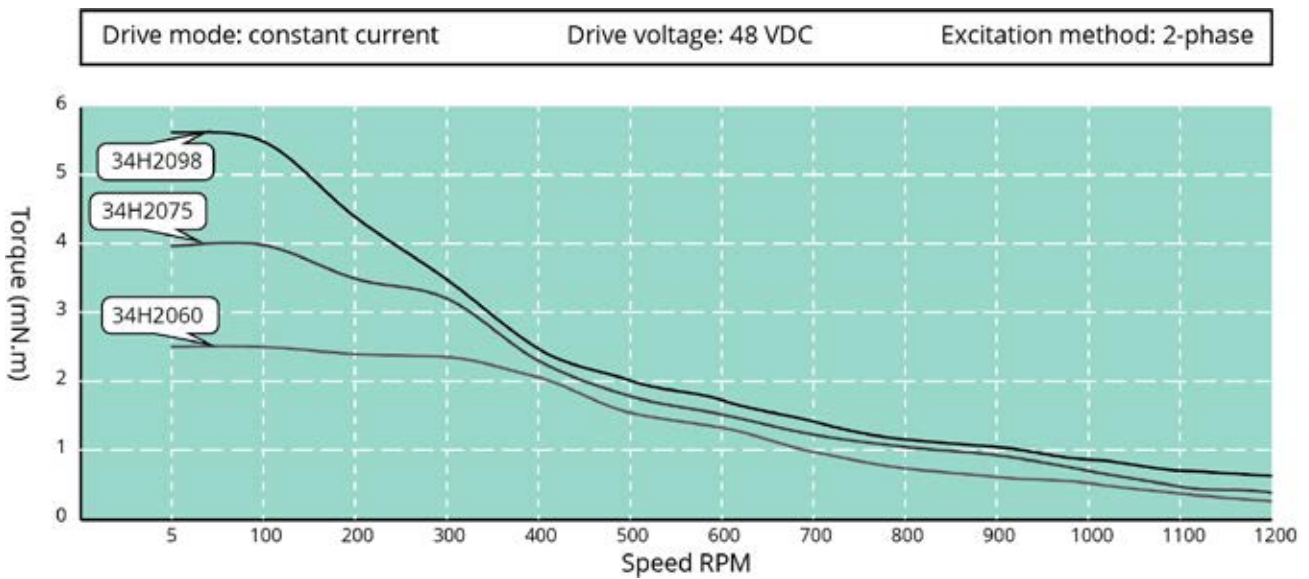

Note : All drawings are 1st Angle Projection - ISO Compliant (3D models available)